



COLLEGE of AMERICAN  
PATHOLOGISTS

# Overview: 2022 Changes to the Pathology Quality Measures

---

## Pathologists Quality Registry

Quality Measures Team

January 21, 2022

# Confidentiality Statement

- *The information in this presentation is copyright 2021 College of American Pathologists (CAP). All rights reserved. The CAP owns all rights, title, and interests in the quality measures. The quality measures are provided solely for the benefit of CAP, its members and the Pathologists Quality Registry for the purposes specified herein and for other CAP purposes. It may not be used by other parties except with prior written approval of the CAP. CPT copyright 2021 American Medical Association.*
  - *The information contained in this presentation is for CAP Registry Enrollees and data entry personnel only. Circulation of this presentation to a non-CAP Registry Enrollee is NOT permitted.*
  - *Please consult with one of our members from the CAP Quality Team at [measures@cap.org](mailto:measures@cap.org) or CAP Registry Team at [Registry.Inquiries@cap.org](mailto:Registry.Inquiries@cap.org) for any questions about our confidentiality statement.*

# 2022 Pathology Specialty Measure Set

Measure Name/ID	Denominator	Numerator	Exclusion/Exception
<b>QPP 249: Barrett's Esophagus Reporting</b>	<p><b>No changes made for 2022</b></p> <p>Esophageal biopsies with histological finding of Barrett's mucosa</p>	<p><b>No changes made for 2022</b></p> <p>Path reports with a statement about dysplasia (if present, also include appropriate grading)</p>	<p><b>Exclusion: No changes made for 2022;</b> Specimens other than from the esophagus</p> <p><b>Exception: No changes made for 2022;</b> Absence of intestinal metaplasia, malignant neoplasm</p>
<b>QPP 250: Radical Prostatectomy Reporting</b>	<p><b>No changes made for 2022</b></p> <p>Radical prostatectomies with a diagnosis of prostate cancer</p>	<p><b>No changes made for 2022</b></p> <p>Path reports with documentation of pT category, pN category, Gleason score, and margin status</p>	<p><b>Exclusion: No changes made for 2022;</b> Specimens other than from the prostate</p> <p><b>Exception: No changes made for 2022</b> TURP, malignant neoplasm</p>
<b>QPP 395: Lung Cancer Reporting (Biopsy/Cytology)</b>	<p><b>No changes made for 2022</b></p> <p>Biopsy/cytology specimens with a diagnosis of primary NSCLC</p>	<p><b>Yes – changes made for 2022</b></p> <p>Path reports must classify specimens into histology type following IASLC guidance or with an explanation for NSCLC-NOS (not otherwise specified)</p> <p><u>*IASLC Guidelines:</u></p> <ol style="list-style-type: none"> <li>1. Don't use "large cell carcinoma"</li> <li>2. Don't use "AIS" (adenocarcinoma in situ) or "MIA" (minimally invasive adenocarcinoma)</li> <li>3. Don't use "BAC" (bronchioloalveolar carcinoma)</li> </ol>	<p><b>Exclusion: No changes made for 2022;</b> Specimens other than from the lung or not classified as primary NSCLC</p> <p><b>Exception: Yes - changes made for 2022;</b> Added: Insufficient tissue, specimen is non-diagnostic, no residual carcinoma, etc.</p>

# 2022 Pathology Specialty Measure Set

Measure Name/ID	Denominator	Numerator	Exclusion/Exception
<b>QPP 396: Lung Cancer Reporting (Resections)</b>	<p><b>No changes made for 2022</b></p> <p>Lung resection specimens for primary lung carcinoma</p>	<p><b>No changes made for 2022</b></p> <p>Path reports with documentation of pT category, pN category, and histologic type for NSCLC specimens</p>	<p><b>Exclusion: No changes made for 2022;</b> Specimens other than from the lung, NSCLC-NOS specimens</p> <p><b>Exception: Yes - changes made for 2022</b> Added: metastatic carcinoma, no residual carcinoma, insufficient tissue, etc.</p>
<b>QPP 397: Melanoma Reporting</b>	<p><b>No changes made for 2022</b></p> <p>Biopsy and wide/re-excision specimens for primary malignant cutaneous melanoma</p>	<p><b>Yes – changes made for 2022</b></p> <p>Path reports must include documentation of peripheral and deep margin status and presence/absence of <u>microsatellitosis</u> in addition to pT category, thickness, ulceration, and mitotic rate</p>	<p><b>Exclusion: No changes made for 2022;</b> Specimens other than from the skin, melanoma in situ</p> <p><b>Exception: No changes made for 2022</b> Negative skin biopsies, insufficient tissue, etc.</p>
<b>QPP 440: Skin Cancer Biopsy Reporting Time – Pathologist to Clinician</b>	<p><b>No changes made for 2022</b></p> <p>Biopsy specimens (excludes wide/re-excisions) for cutaneous basal cell carcinoma, squamous cell carcinoma, or melanoma/melanoma in situ</p>	<p><b>No changes made for 2022</b></p> <p>Path reports available to the requesting physician within 7 days (includes weekends and holidays)</p>	<p><b>Exclusion: No changes made for 2022;</b> Second opinion, Pathologist or dermatopathologist is the biopsying clinician</p> <p><b>No Exception: No changes made for 2022</b></p>



# Available Educational Resources

- **Quality Measure and Data Entry Tool Resources**

- Guidance documents and tutorial videos about the QCDR measures and data entry tools (e.g. Webtool and CSV Bulk Upload)
- Accessible via the Resource Library of the Registry:
  - Go to your **Quality Dashboard** and click on the **Help** icon in the top right-hand corner.
  - Then, click on the **Registry Documents** icon. You will see the resource documents and videos posted.

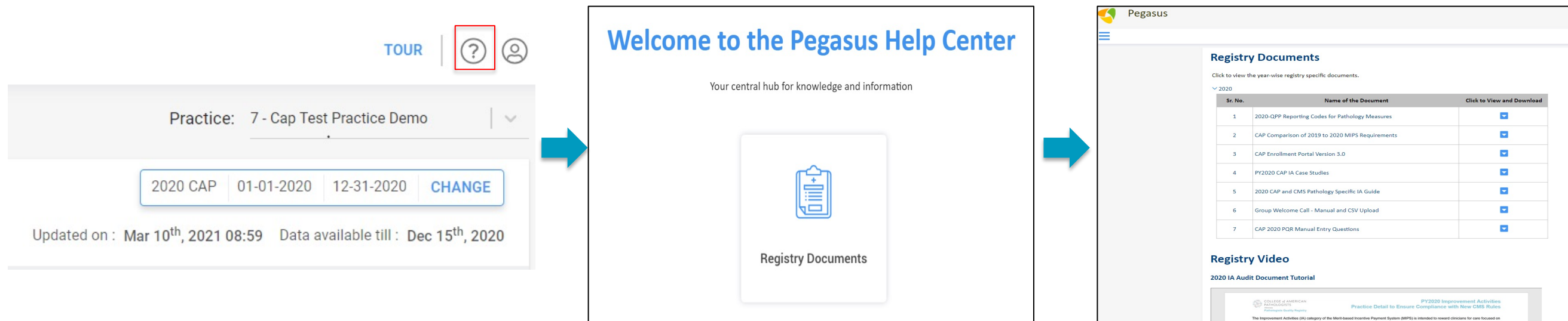

# Questions?

For measure questions, contact the CAP Quality Measures Team at [measures@cap.org](mailto:measures@cap.org)

For data mapping questions, please contact your Client Account Managers (CAPCAMS) at [capcams@figmd.com](mailto:capcams@figmd.com)



COLLEGE of AMERICAN  
PATHOLOGISTS